



24P

HEAVY DUTY SNAP PLIERS

Instruction Guide
for Heavy Duty Snaps



24P HEAVY DUTY SNAP PLIERS – Instructions

Fabric Preparation for Heavy Duty Snaps

Use two layers of medium to heavy-weight fabric, reinforced with interfacing. Mark position of heavy duty snaps on topside and underside of garment. Test a snap on swatch of fabric.

Instructions for Cutting Holes in Fabric

Pliers Tools:

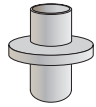

Metal Round Die Base

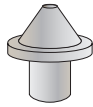

Metal Cone Punch

Inserting Tools:

Insert cone punch in one side of pliers and round die base (small hole opening facing out) in other side.

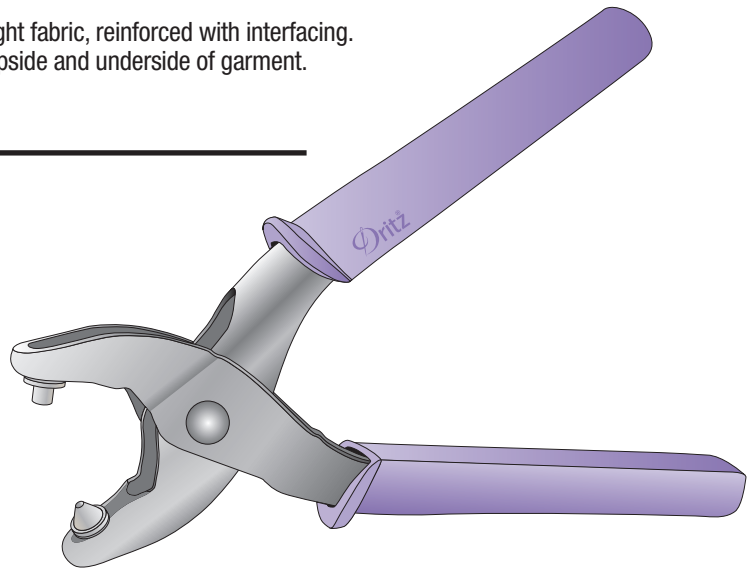

Cutting Holes:

1. Position fabric in pliers and center tools over mark. Squeeze pliers firmly to cut hole.
2. After cutting several holes, it may be necessary to clear hole cutouts from die base. Use a strong straight pin to remove fabric cutouts from die.
3. If pliers' tools will not cut through your specific type of fabric, cut a small hole with scissors.

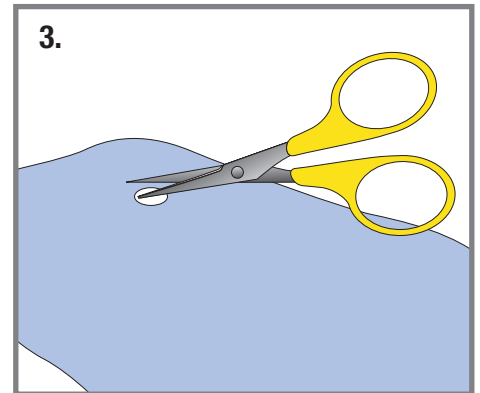
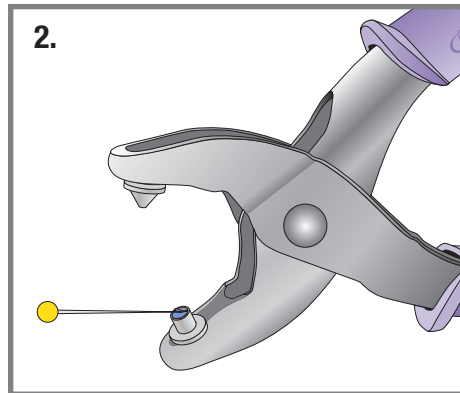
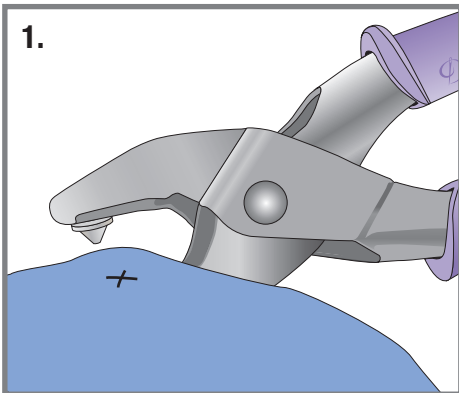

Removing Tools:

Slip hook of gray tool remover inside ledge of pliers and press down to release tool.

Repeat for opposite side.

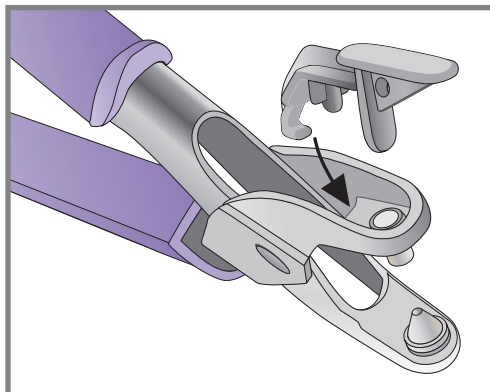

24P HEAVY DUTY SNAP PLIERS – Instructions (continued)

Instructions for Applying Size 24 Heavy Duty Snaps - Cap (Topside of garment)

Snap Parts:



Cap



Socket



Metal Splitting Punch

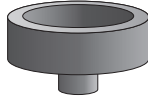

Black Cap Holder

Pliers Tools:

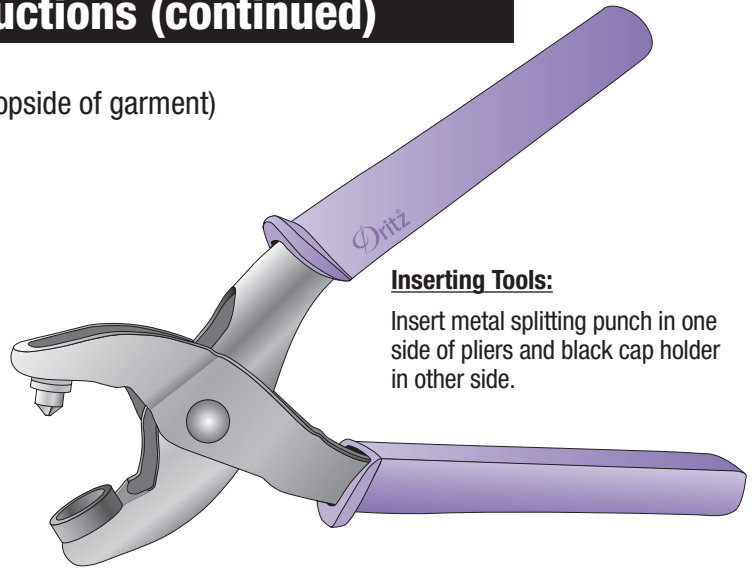

Inserting Tools:

Insert metal splitting punch in one side of pliers and black cap holder in other side.

Instructions:

1. With cap holder at bottom of pliers, place cap into holder.

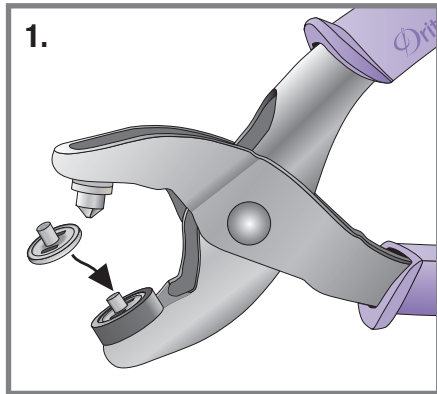

2. Slide hole in fabric over post of cap. Make sure right side of garment is facing cap.

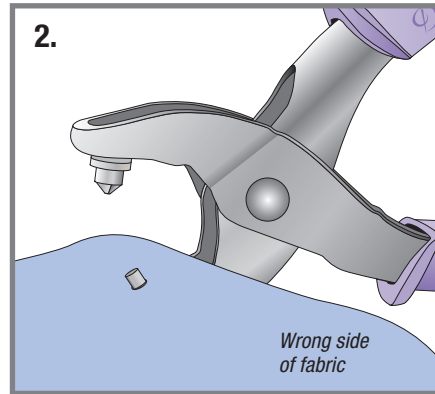

3. Position socket, *bowl side out*, over cap post.

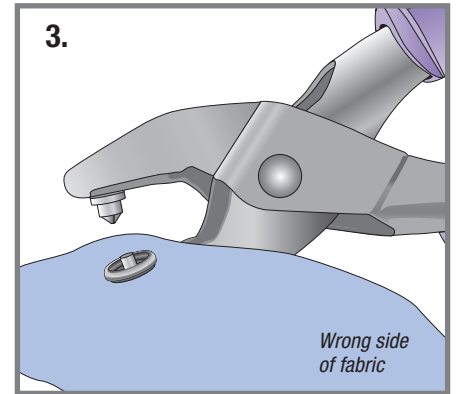

4. Squeeze pliers firmly to apply cap and socket. Check for tightness; squeeze again, if necessary.

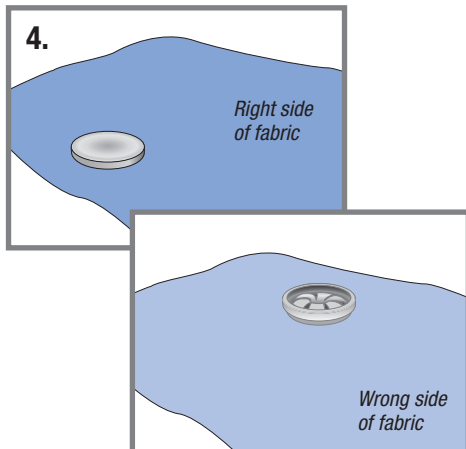

Removing Tool:

Slip hook of gray tool remover inside ledge of pliers and press down to release cap holder tool.

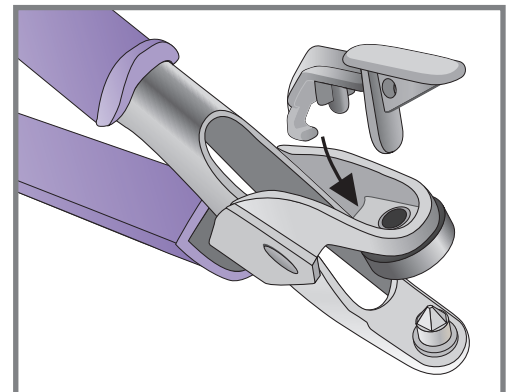

24P HEAVY DUTY SNAP PLIERS – Instructions (continued)

Instructions for Applying Size 24 Heavy Duty Snaps - Stud (Underside of garment)

Snap Parts:

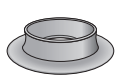

Stud



Post



Metal Splitting
Punch

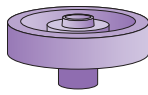

Purple Post
Holder

Pliers Tools:

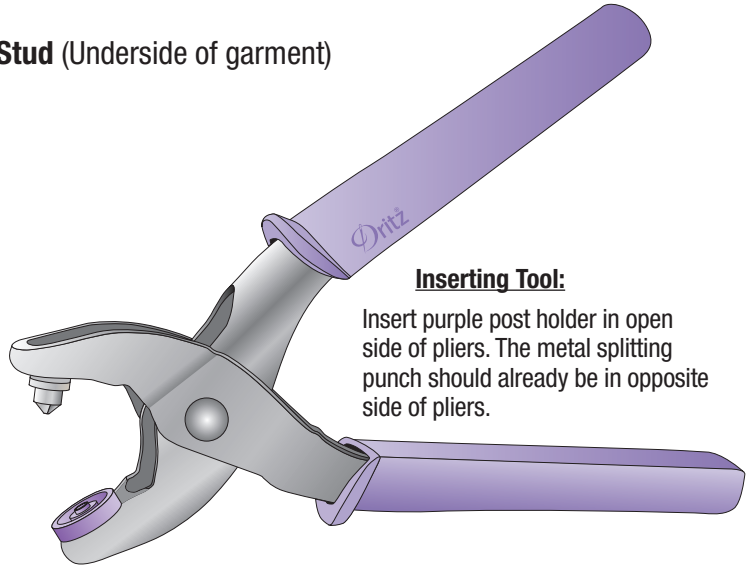

Inserting Tool:

Insert purple post holder in open side of pliers. The metal splitting punch should already be in opposite side of pliers.

Instructions:

1. With post holder at bottom of pliers, place post into holder.

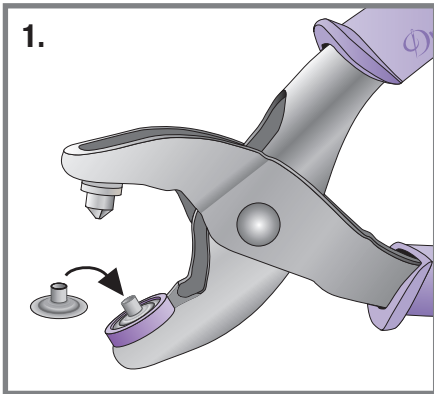

2. Slide hole in garment over post. Make sure wrong side of garment is facing post.

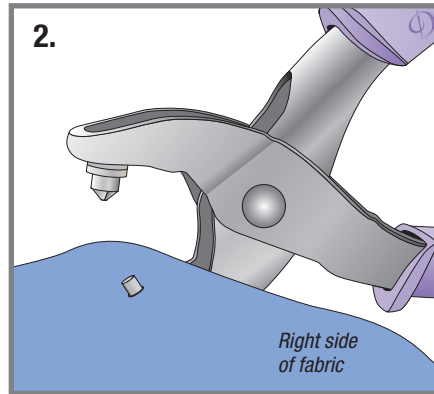

3. Position stud, flat rim down, over post.

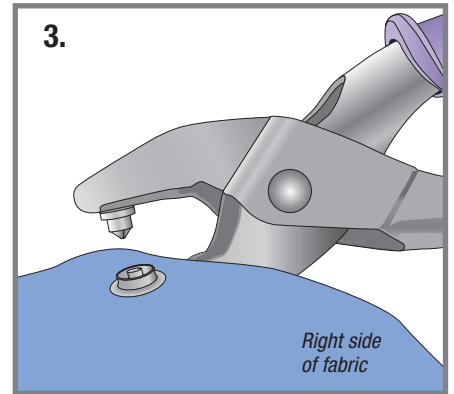

4. Squeeze pliers firmly to apply stud and post. Check for tightness; squeeze again, if necessary.

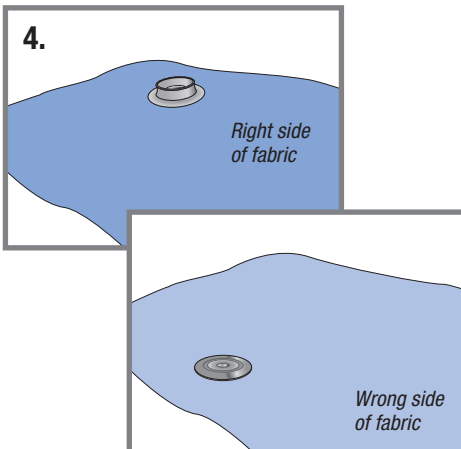

Removing Tools:

Slip hook of gray tool remover inside ledge of pliers and press down to release tool. Repeat for opposite side.

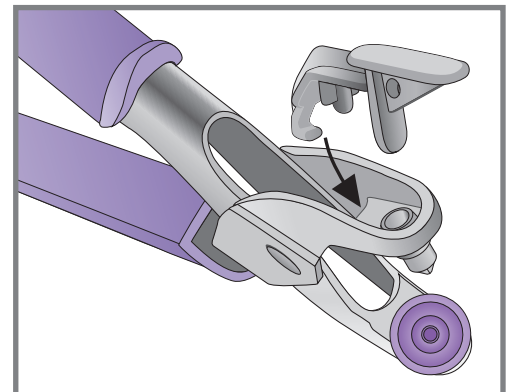

Additional Information

For Reversible Garments

Use a second cap (with black cap holder) instead of post to apply stud.

Snap Parts:

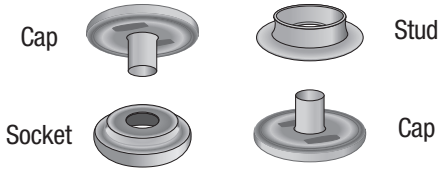

Pliers Tools:

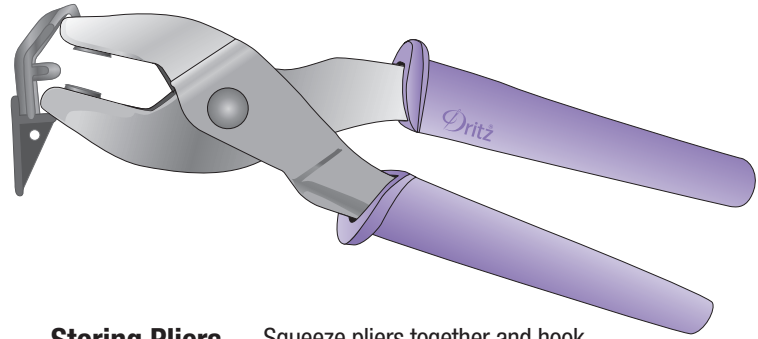
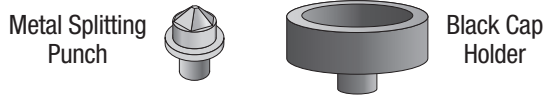

Storing Pliers

Squeeze pliers together and hook gray tool remover at top of pliers.

Replacement Inserts

Replacement inserts have been provided. When tools are no longer staying in pliers well, remove worn insert and replace with new.

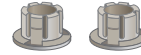

WARNING: Small parts. Keep away from children under 3 years old. NOT A TOY.